

University of California
Livermore Collaboration Center
Room and Seating Layouts

Floor plan with seating occupancy

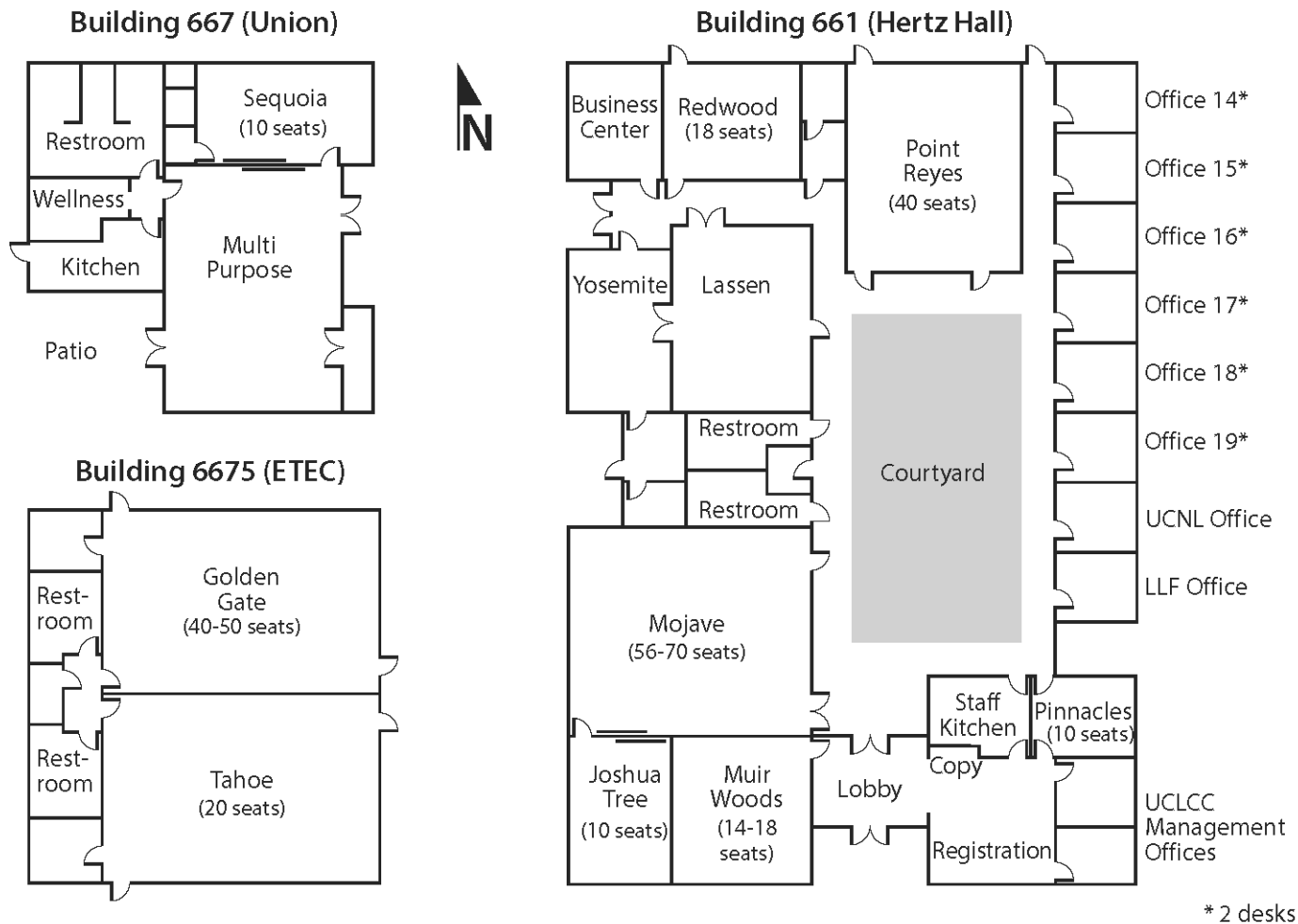

AV Capabilities

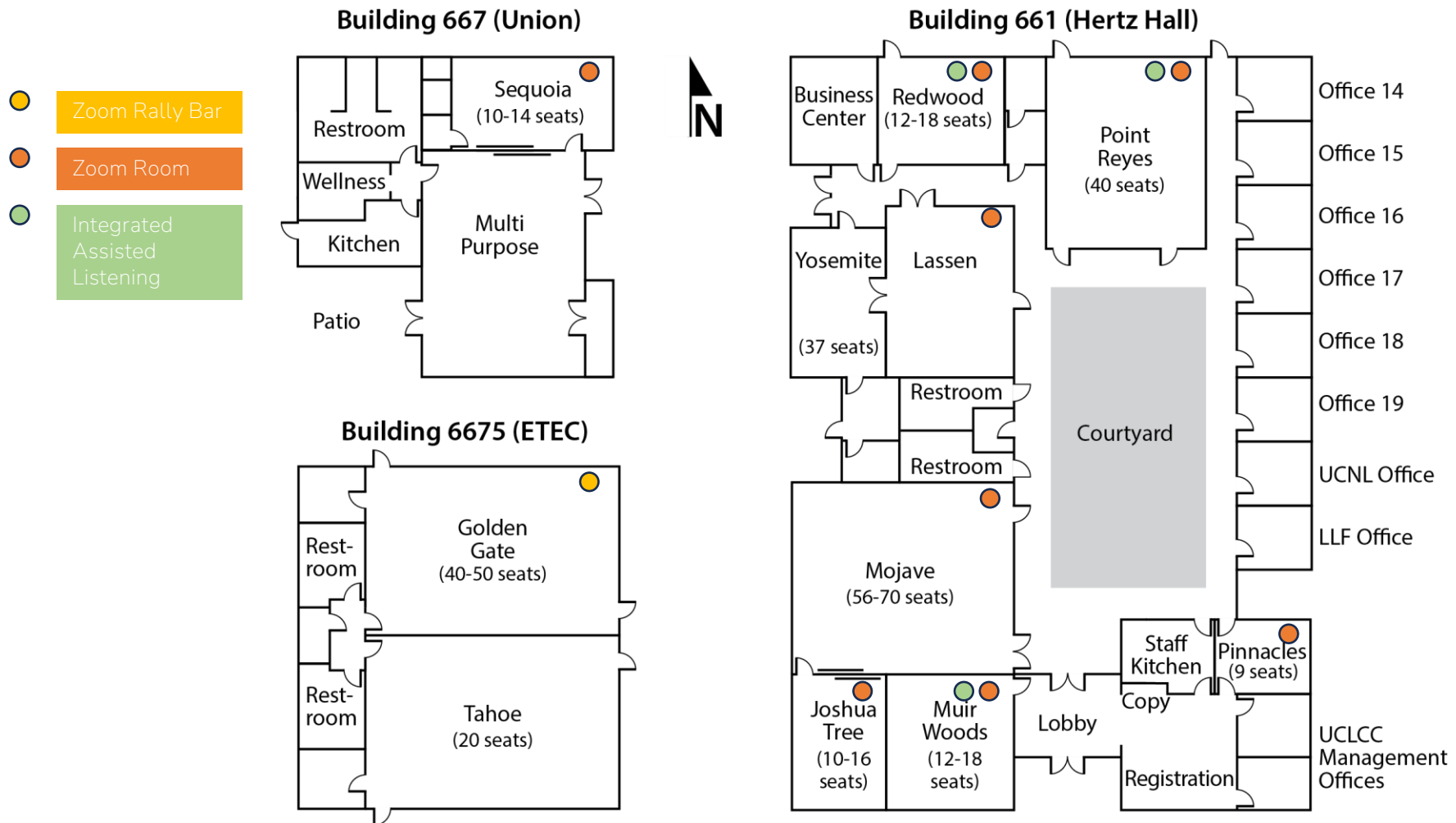

Muir Woods

Hertz Hall, Building 661



Photo shows seven 24" x 48" tables and 18 chairs.

Primary Layout

Seating for 18

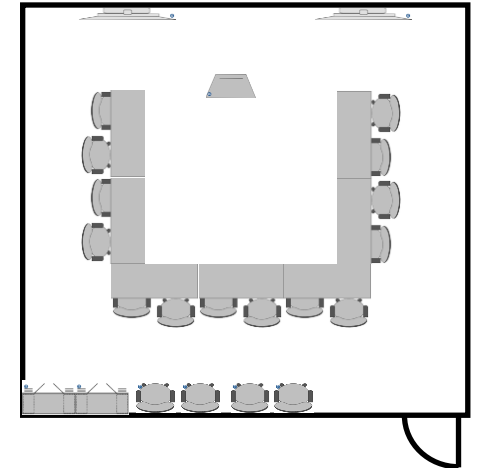

Alternate Layout

Seating for 18

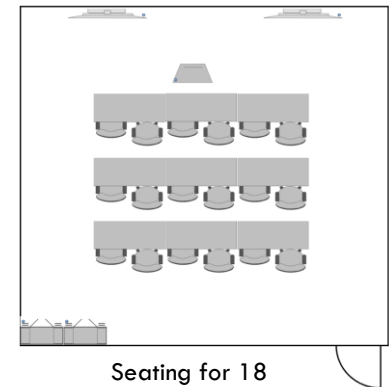

Mojave

Hertz Hall, Building 661



Photo shows twenty-eight 19"x 60" tables and 56 chairs in four rows.

Primary Classroom Layout

Seating for 56

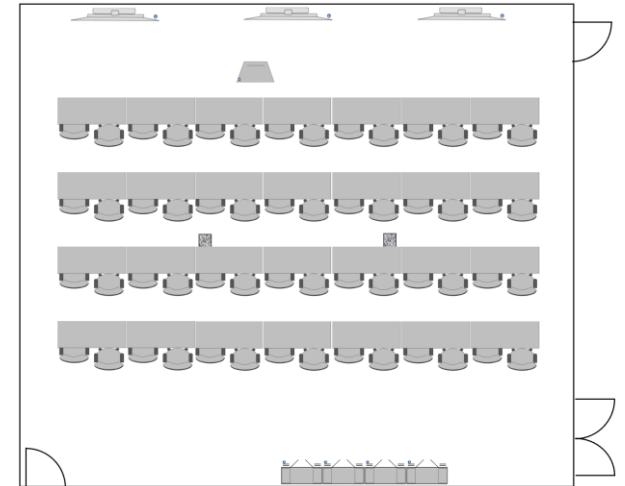

Alternate Layouts

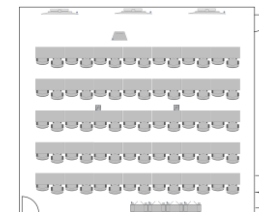

Seating for 70

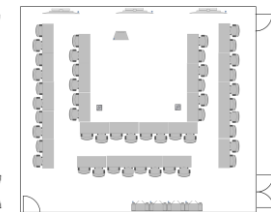

Seating for 48

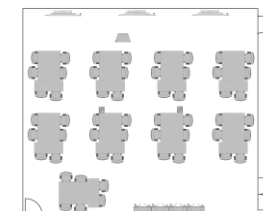

Seating for 54

Joshua Tree

Hertz Hall, Building 661



Photo shows six 24" x 48" tables and 10 chairs.

Standard Layout

Seating for 12

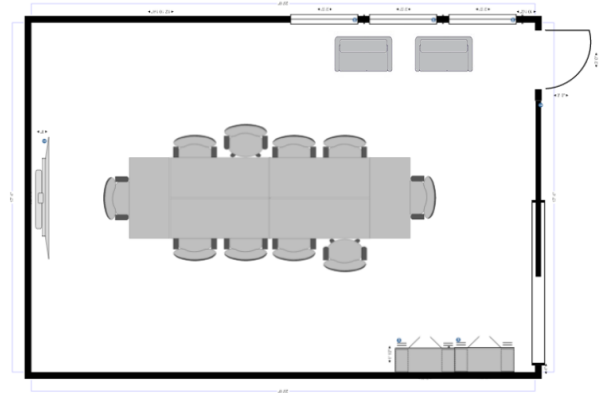

Mojave and Joshua Tree Standard Layout

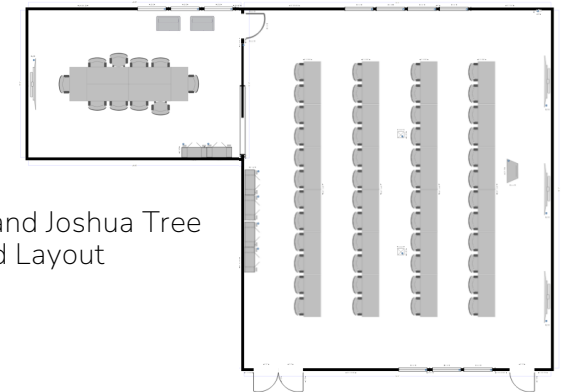

Point Reyes

Hertz Hall, Building 661



Photo shows fifteen 19" x 60" tables and 30 chairs.

Primary Classroom Layout

Seating for 40

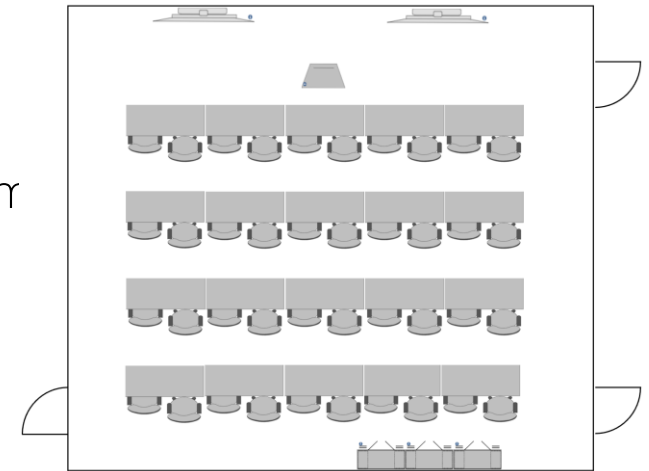

Alternate Layouts

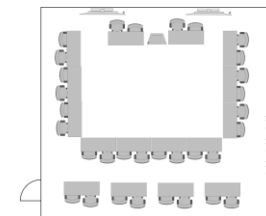

Seating for 32

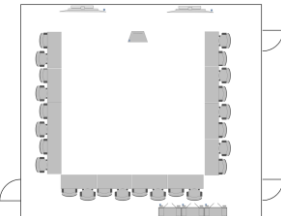

Seating for 24

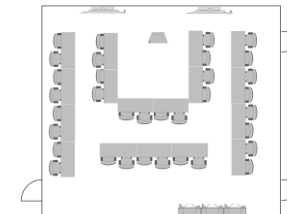

Seating for 34

Redwood

Hertz Hall, Building 661



Photo shows nine 19" x 60" tables and 18 chairs.

Primary Classroom Layout

Seating for 20

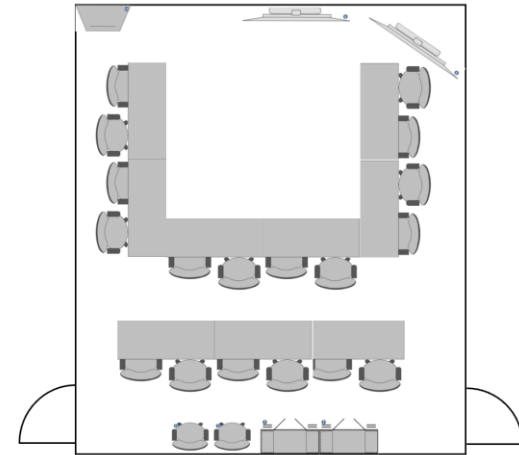

Alternate Layouts

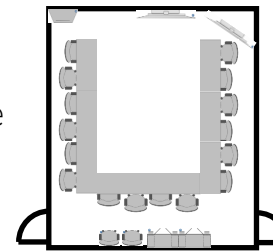

Seating for 18

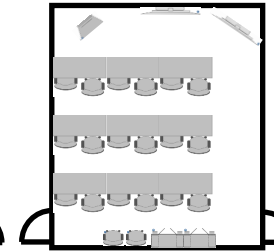

Seating for 20

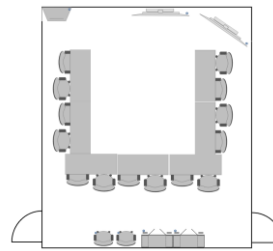

Seating for 16

Multi Purpose

Union, Building 667

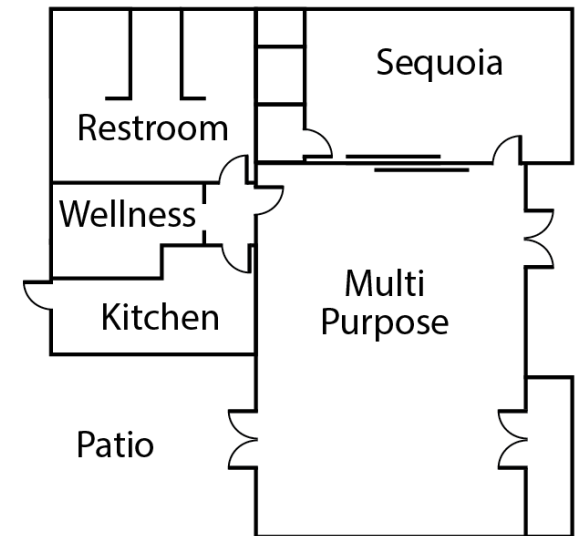

Sequoia

ETEC, Building 667



Photo shows six 24" x 48" tables and 10 chairs.

Standard Layout

Seating for 10

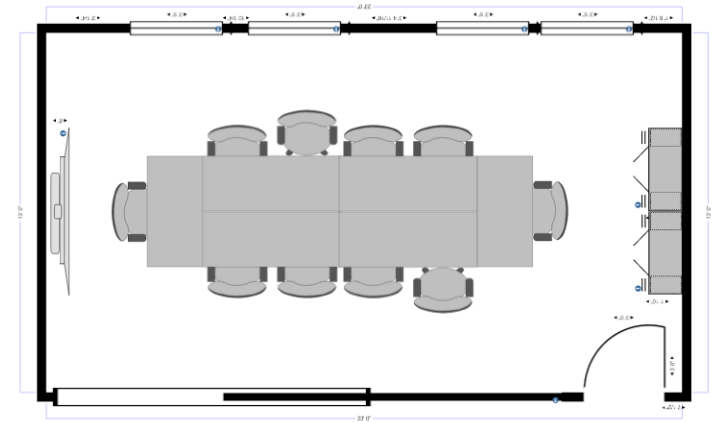

Golden Gate

ETEC, Building 667

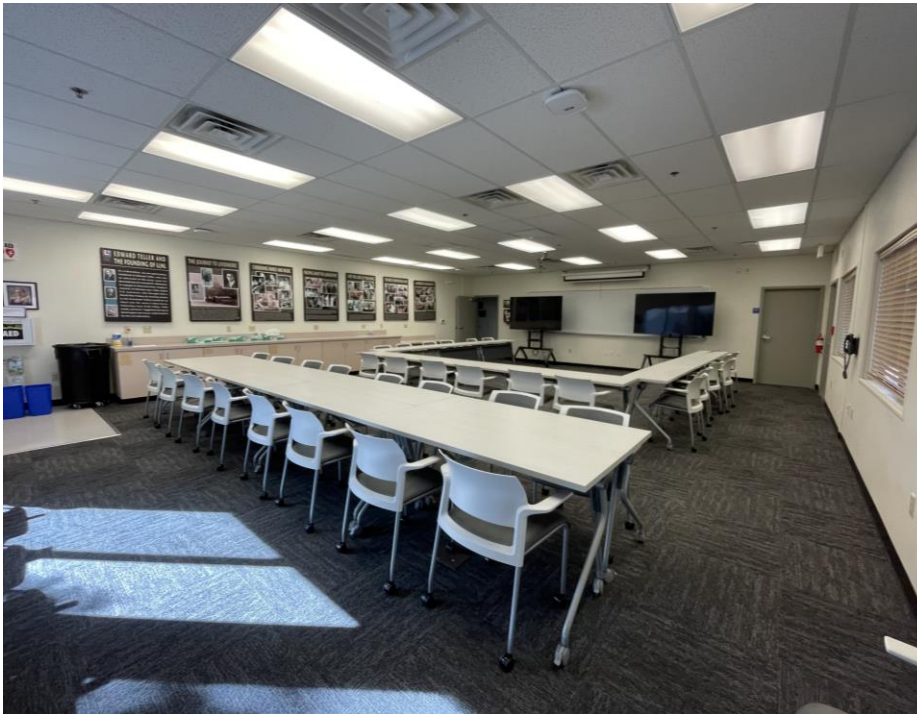
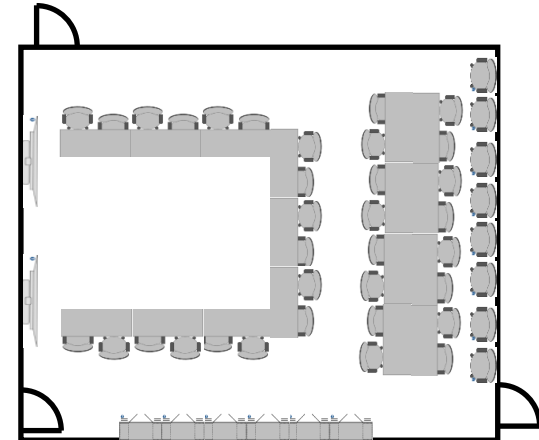

Photo shows fifteen 19"x 60" tables and 42 chairs.

Standard Layout

Seating for 42



Alternate Layout

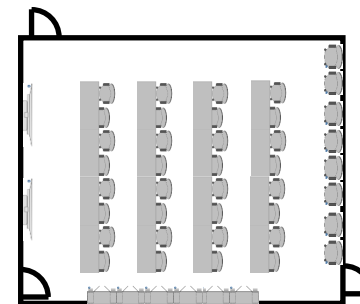

Seating for 40

Tahoe

ETEC, Building 667



Photo shows twelve 24" x 48" tables and 24 chairs.

Interactive Classroom Layout

Seating for 32

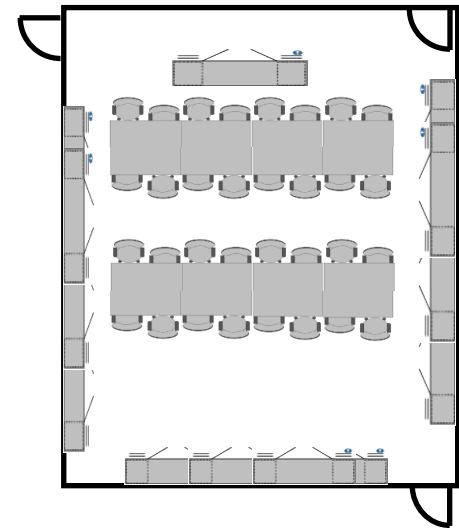

Yosemite and Lassen

Hertz Hall, Building 661

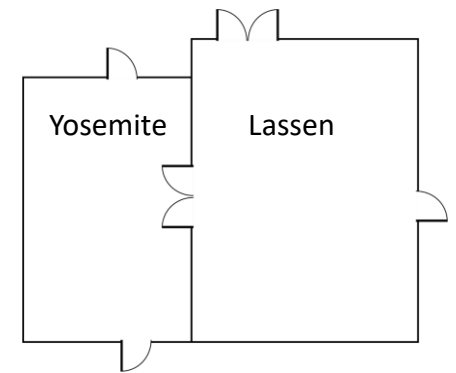
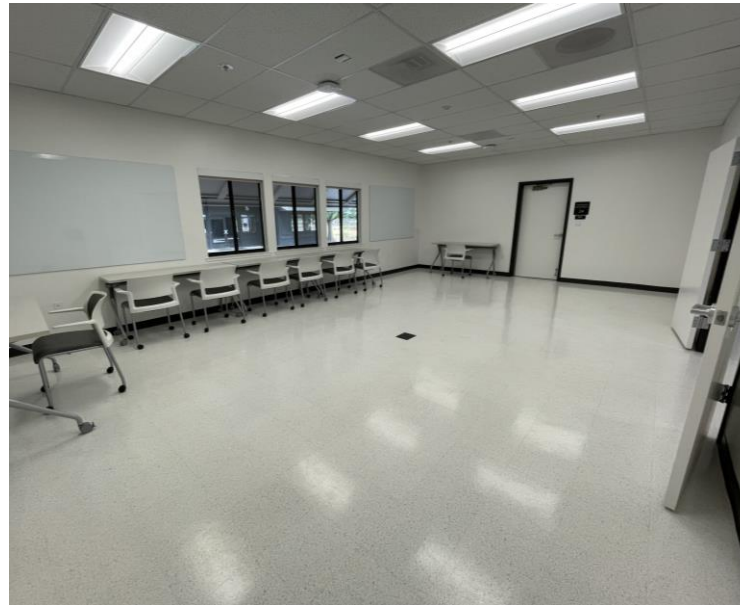

Photo shows eight 24" x 48" tables and 16 chairs.

Hoteling Offices

Hertz Hall, Building 661



Photo show 2 desks with chairs, and one small round table with two chairs.

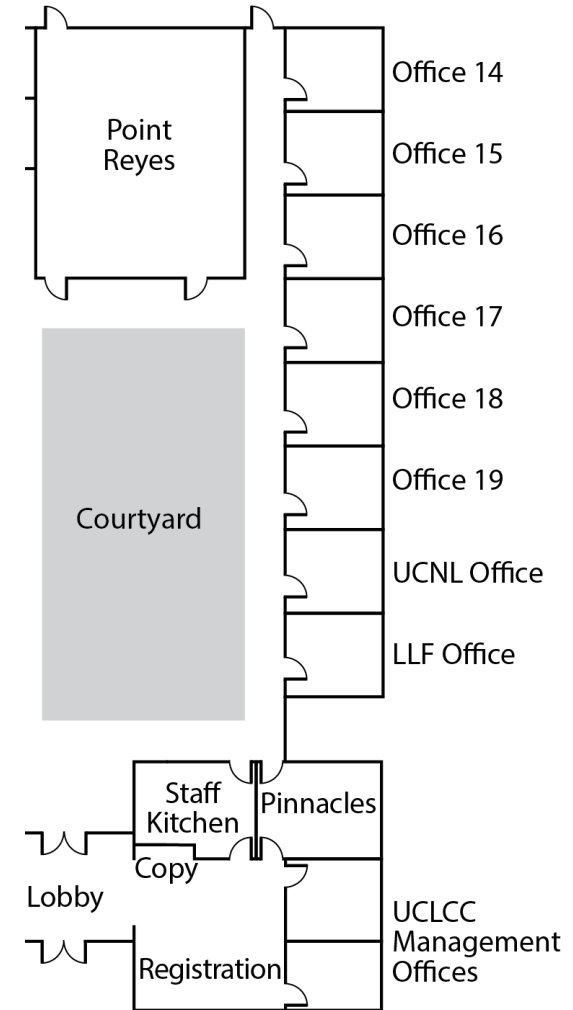

Lobby

Hertz Hall, Building 661



Central Courtyard

Hertz Hall, Building 661

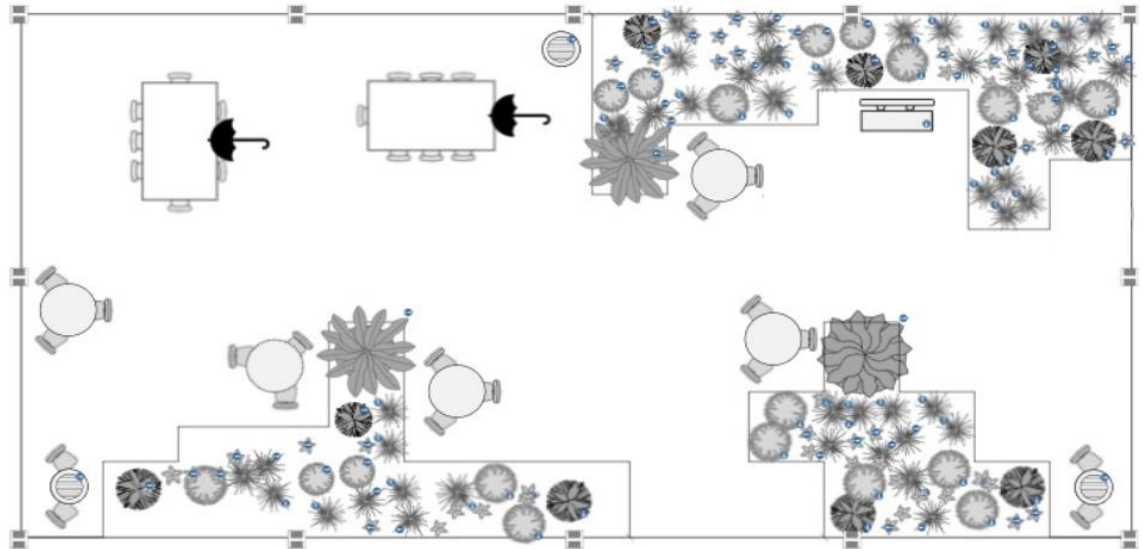

Image shows two 24" x 60" tables, eight round tables, bench and seating for 37.

Pinnacles

Hertz Hall, Building 661



Photo shows one conference table and 7 chairs.

Standard
Layout

Seating for 7

